

PART TO BE COATED WITH NICKEL !!

REVISION HISTORY			
REV	DESCRIPTION	BY	REV DATE

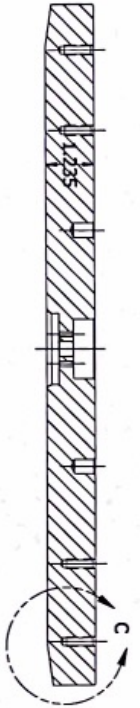
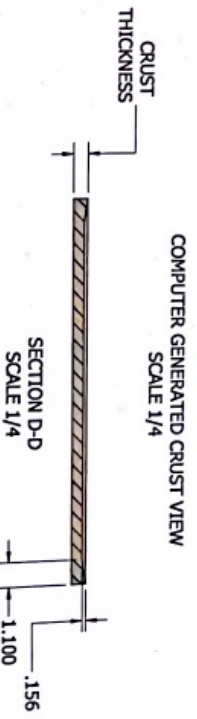
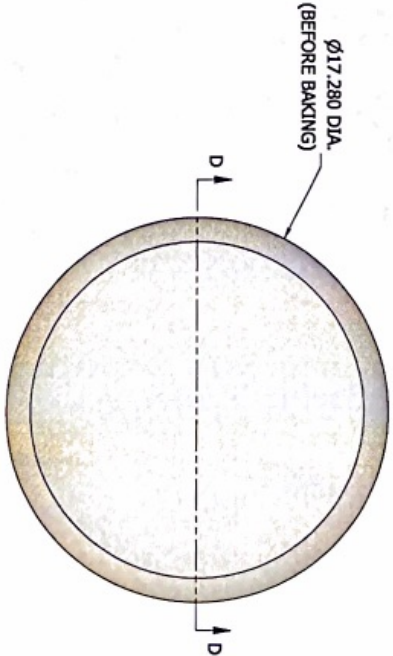
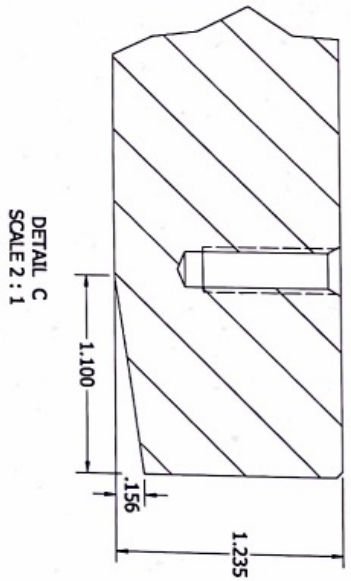
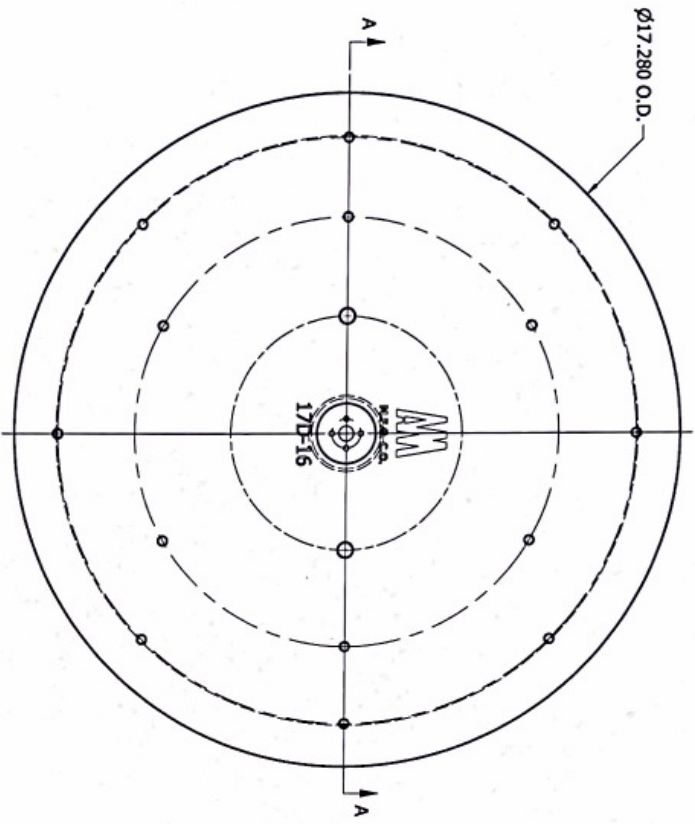

SECTION A-A
SCALE 7/16

NOTE

- CUSTOMER PROVIDED SAMPLE CRUST DIA = 17.280"
- CUSTOMER PROVIDED SAMPLE CRUST TAPER LG = 1.100" & HEIGHT = 0.15625"

APPROVAL SIGNATURE

DATE

8/25/23

M Manufacturing Company 9200 Central Ave. Suite 101 Houston, TX 77036		VACUUM PRESS W/ AIR ASSIST PART # 17D-16 QTY 1000 DATE 8/15/2023	
DESIGNED BY: [Signature] CHECKED BY: [Signature] DATE: 8/15/2023	DRAWN BY: [Signature] CHECKED BY: [Signature] DATE: 8/15/2023	MATERIAL: 17D-16 QUANTITY: 1000 DATE: 8/15/2023	PART # 17D-16 QTY 1000 DATE 8/15/2023

BILL OF MATERIAL

ITEM	PART NO	DESCRIPTION	QTY
1	02-17PT5	DIE PLATE (2 ON 17.280" W/ AIR)	1
2	100-05AN	AIR RELEASE VALVE-NICKEL COATED	2
3	100-05B	AIR RELEASE VALVE RETENTION PLATE	2
4	100-05E	AIR RELEASE DIE SPRING	2
5	17D-16	17.280 IN DIA DIE-TAPER EDGE & AIR	2
6	17R-15	FLANGED RING (FOR 17.280" FORMING DIE)	2
7	21201	AIR DIE INLET FITTING KEEPER	4
8	DIS	DIE SPRING, .460" OD X 1 1/4" LG, 9	62
9	F0400FW	FLAT WASHER, 1/4"	4
10	F0400LW	LOCK WASHER, 1/4"	4
11	F0404SH	SCREW, SOCKET HEAD 1/4-20 X 1" LG	16
12	F0404SS	SET SCREW, 1/4-20 X 1" LG, S.S.	4
13	F0405HCS	HEX HEAD CAP SCREW 1/4-20 X 1-1/4"	4
14	F0500NCHN	5/16-18 HALF NUT	2
15	F0503SHSB	SOCKET HEAD SHOULDER BOLT, 5/16" DIA SHOULDERX3/4" LG, 1/4-20 STD THREADS	16
16	F0804SHSB	BOLT, SHOULDER 1/2" DIA X 1" LG X 3/8-16	6

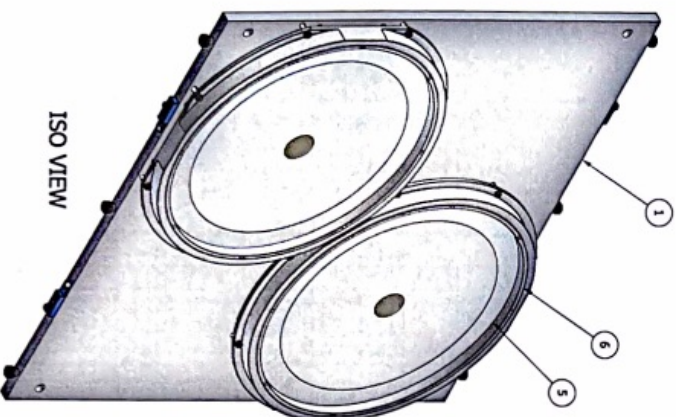

PRODUCT FLOW

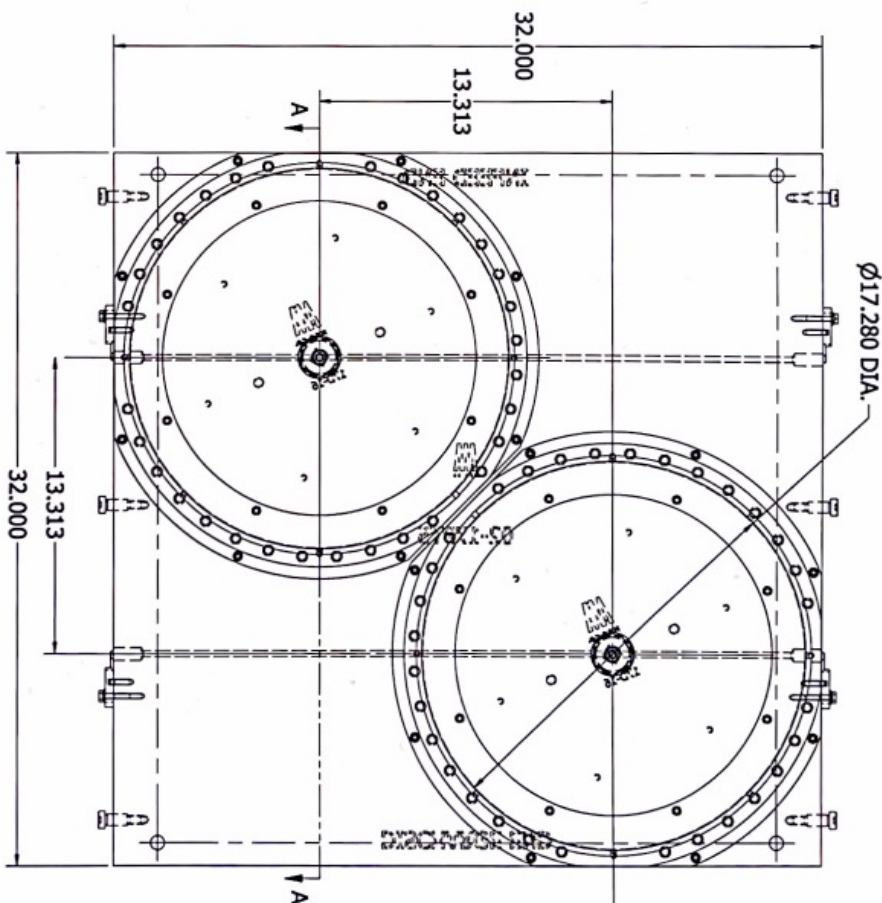

APPROVAL SIGNATURE

DATE

8/25/23

<p>manufacturing company</p>		<p>REV</p>	
<p>1000 Clarendon Ave. Suite 100 of Marine, N. 46321</p>		<p>DESCRIPTION</p>	
<p>DATE</p>		<p>BY</p>	
<p>SCALE</p>		<p>REV DATE</p>	
<p>8/15/2023</p>		<p>DA-17-280-1016</p>	